

\\BIL-HG-F504\BIL-Projects\22\14258-01\65CAD\Landscapes\DD\SC14-LS-PG-KELL.dwg PLOT DATE: 2017-04-12 14:28 SAVED DATE: 2017-04-12 14:17 USER: pggdytor

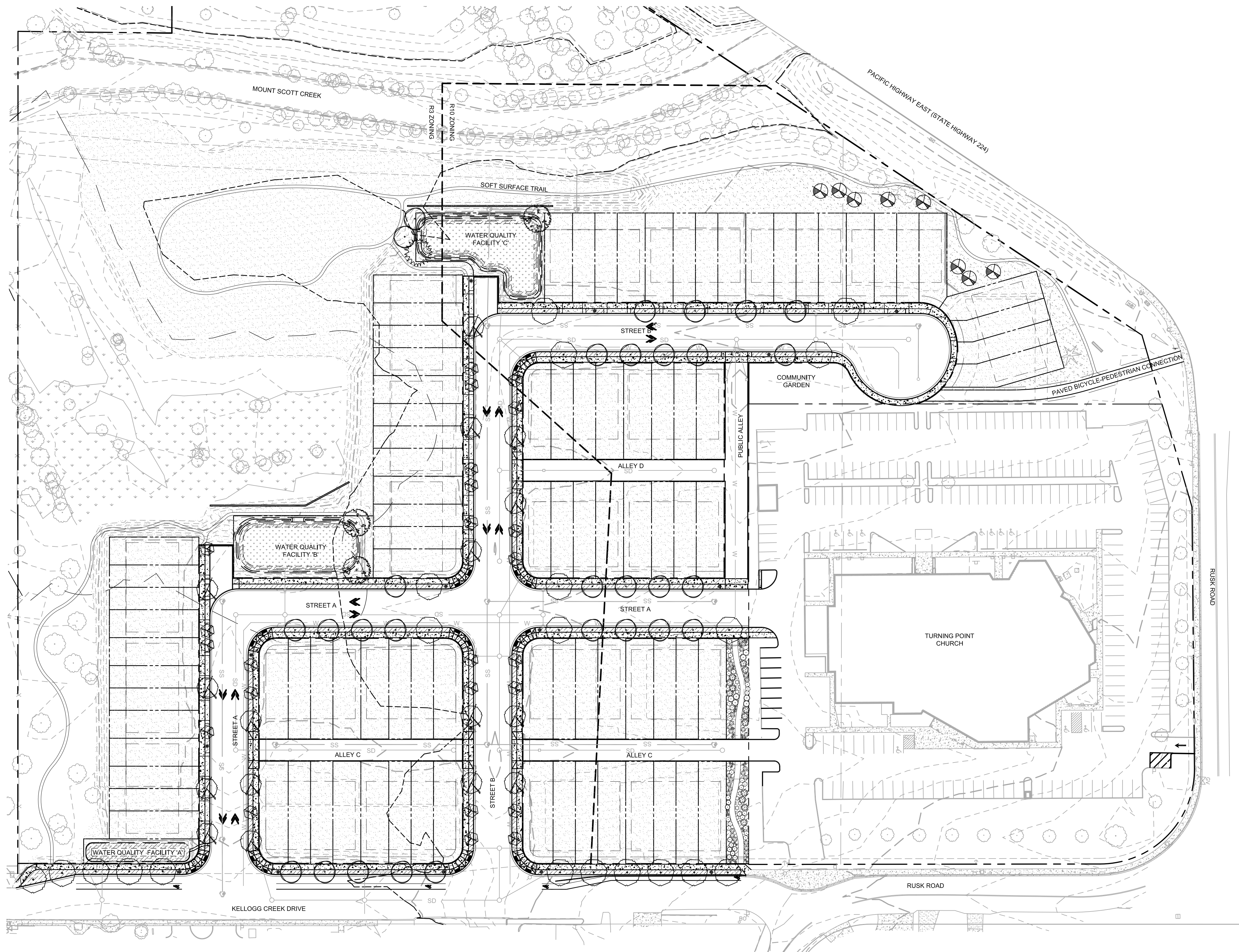

FRONTAGE AND OPEN SPACE MATERIALS LEGEND

TREES ITEM	SIZE / SPACING	QUANTITY
A. TRUN. x A. PLAT. 'WARRENRED' PACIFIC SUNSET MAPLE	1.5" CAL. / B&B AS SHOWN	20
ACER GRISEUM PAPERBARK MAPLE	1.5" CAL. / B&B AS SHOWN	29
GINKGO BILOBA 'PRINCETON SENTRY' PRINCETON SENTRY GINKGO	1.5" CAL. / B&B AS SHOWN	16
CARPINUS BETULUS 'FRANS FONTAINE' FRANS FONTAINE HORNBEAM	1.5" CAL. / B&B AS SHOWN	24
THUJA PLICATA WESTERN RED CEDAR	4' HEIGHT MINIMUM	8
EXISTING TREE TO REMAIN	AS NOTED	

SHRUBS & ACCENTS ITEM	SIZE / SPACING	QUANTITY
MAHONIA AQUIFOLIUM OREGON GRAPE	1 GAL. AS SHOWN	26
RIBES SANGUINEUM RED-FLOWERING CURRENT	3 GAL. AS SHOWN	17
VACCINIUM OVATUM EVERGREEN HUCKLEBERRY	3 GAL. AS SHOWN	13
ROSMARINUS OFFICINALIS 'ARP' ARP ROSEMARY	1 GAL. AS SHOWN	29
CAL. ACUTIFLORA 'KARL FOERSTER' KARL FOERSTER REED GRASS	1 GAL. AS SHOWN	34

GROUNDCOVERS & MISCELLANEOUS ITEM	SIZE / SPACING	QUANTITY
ARCTO. UVA-URSI 'MASSACHUSETTS' MASSACHUSETTS KINNICKINNICK	1 GALLON 3'-0" O.C.	15,068 SF 1,928 PLANTS
NATIVE EROSION CONTROL GRASS MIX SUNMARK SEEDS - FAIRVIEW, OR	SEED @ 1 LBS. / 1,000 SF	277,682 SF 278 LBS
CROCUS V. 'GIANT DUTCH' & N. TETE-A-TETE GIANT CROCUS & TETE-A-TETE DAFFODIL	BULBS 20 / 100 SF	405 SF 80 BULBS
SOFT SURFACE TRAIL	2'-6" WIDTH	

WATER QUALITY FACILITY MATERIALS LEGEND

TREES ITEM	SIZE / SPACING	QUANTITY
ACER GRISEUM PAPERBARK MAPLE	1.5" CAL. / B&B AS SHOWN	2
ALNUS RUBRA RED ALDER	1.5" CAL. / B&B AS SHOWN	3
PSEUDOTSUGA MENZIESII DOUGLAS FIR	6' HT / B&B AS SHOWN	1
EXISTING TREES TO REMAIN	AS NOTED	

SHRUBS & ACCENTS ITEM	SIZE / SPACING	QUANTITY
MAHONIA AQUIFOLIUM OREGON GRAPE	2 GALLON 7 PLANTS / 100 SF	69
CORNUS SERICEA RED TWIG DOGWOOD	2 GALLON 7 PLANTS / 100 SF	69
ROSA NOOTKANA NOOTKA ROSE	2 GALLON 7 PLANTS / 100 SF	69

GROUNDCOVERS & MISCELLANEOUS ITEM	SIZE / SPACING	QUANTITY
ARCTO. UVA-URSI 'MASSACHUSETTS' MASSACHUSETTS KINNICKINNICK	1 GALLON 70 / 100 SF	2,471 SF 1,729 PLANTS
SEDGE / RUSH MIX 50% CAREX STIPATA 50% JUNCUS PATENS	1 GALLON 80 PLANTS / 100 SF	7,343 SF 5,874 PLANTS

STORMWATER FACILITY REQUIREMENTS:

ZONE A TOTALS: 7,343 SF
 REQUIRES: 80 HERBACEOUS / 100 SF = 5,874 HERBACEOUS
 PROPOSED: 5,874 HERBACEOUS

ZONE B TOTALS: 2,946 SF
 REQUIRES: 7 SHRUBS / 100 SF = 207 SHRUBS
 PROPOSED: 207 SHRUBS (MIX OF SPECIES)

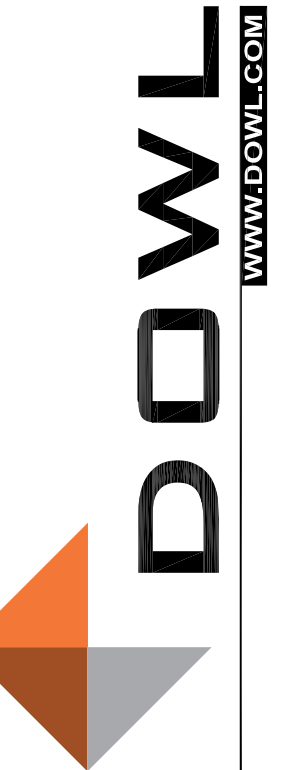
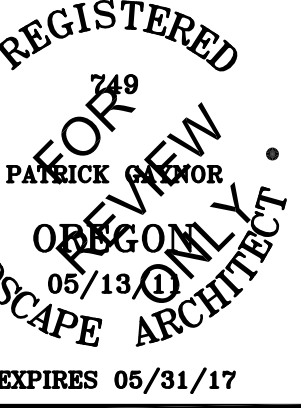

KELLOGG CREEK SUBDIVISION

PLANTING PLAN - OVERALL
 BROWNSTONE DEVELOPMENT
 MILWAUKIE, OREGON

SET/17 NE 1/4 SEC. 6 T2S R2E W1M. EXISTING TAXLOTS 600, 700, 900, 901.

PROJECT 14258-01
 DATE 04/07/2017

© DOWL 2016
 SHEET

L100

\\BL-HG-F504\BIL-Projects\22\14258-01\65CAD\landscape\DD\SC14-LS-PG-KELL.dwg PLOT DATE: 2017-04-12 14:30 SAVED DATE: 2017-04-12 14:17 USER: pggynor

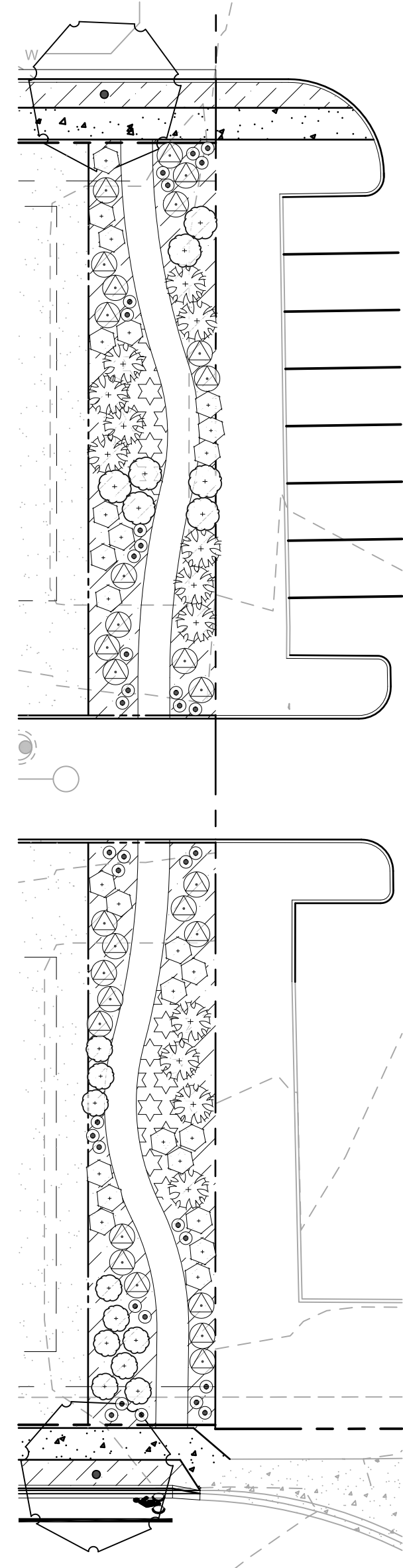

A OPEN SPACE TRACTS

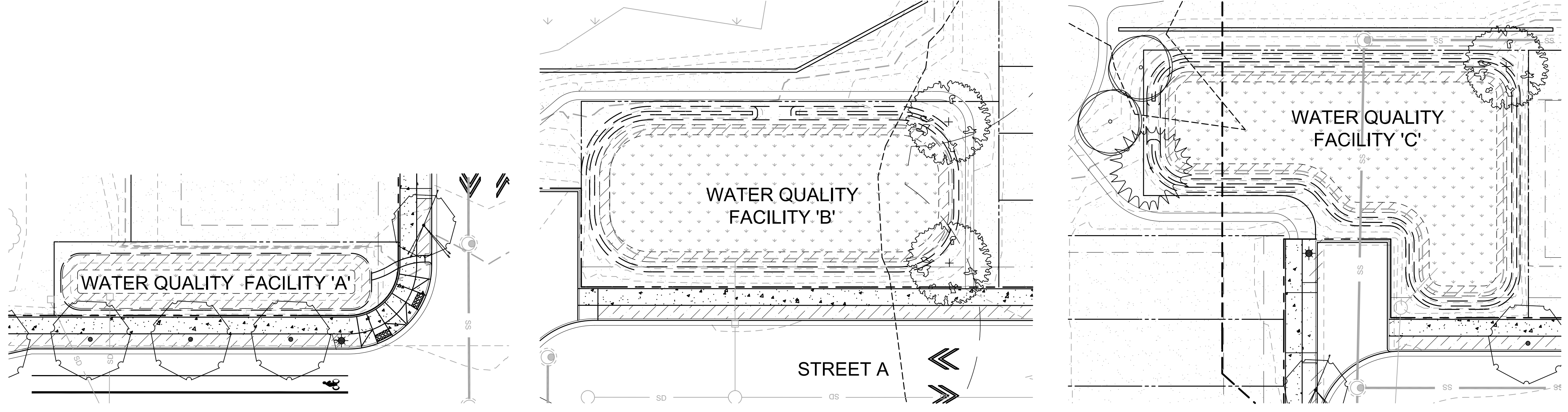

B WATER QUALITY FACILITIES

FRONTAGE AND OPEN SPACE MATERIALS LEGEND

TREES ITEM	SIZE / SPACING	QUANTITY
A. TRUIN. x A. PLAT. 'WARRENRED' PACIFIC SUNSET MAPLE	1.5" CAL. / B&B AS SHOWN	20
ACER GRISEUM PAPERBARK MAPLE	1.5" CAL. / B&B AS SHOWN	29
GINKGO BILOBA 'PRINCETON SENTRY' PRINCETON SENTRY GINKGO	1.5" CAL. / B&B AS SHOWN	16
CARPINUS BETULUS 'FRANS FONTAINE' FRANS FONTAINE HORNBEAM	1.5" CAL. / B&B AS SHOWN	24
THUJA PLICATA WESTERN RED CEDAR	4' HEIGHT MINIMUM	8
EXISTING TREE TO REMAIN	AS NOTED	

SHRUBS & ACCENTS ITEM	SIZE / SPACING	QUANTITY
MAHONIA AQUIFOLIUM OREGON GRAPE	1 GAL. AS SHOWN	26
RIBES SANGUINEUM RED-FLOWERING CURRENT	3 GAL. AS SHOWN	17
VACCINIUM OVATUM EVERGREEN HUCKLEBERRY	3 GAL. AS SHOWN	13
ROSMARINUS OFFICINALIS 'ARP' ARP ROSEMARY	1 GAL. AS SHOWN	29
CAL. ACUTIFLORA 'KARL FOERSTER' KARL FOERSTER REED GRASS	1 GAL. AS SHOWN	34

GROUNDCOVERS & MISCELLANEOUS ITEM	SIZE / SPACING	QUANTITY
ARCTO. UVA-URSI 'MASSACHUSETTS' MASSACHUSETTS KINNICKINNICK	1 GALLON 3'-0" O.C.	15,068 SF 1,928 PLANTS
NATIVE EROSION CONTROL GRASS MIX SUNMARK SEEDS - FAIRVIEW, OR	SEED @ 1 LBS. / 1,000 SF	277,682 SF 278 LBS
CROCUS V. 'GIANT DUTCH' & N. TETE-A-TETE GIANT CROCUS & TETE-A-TETE DAFFODIL	BULBS 20' / 100 SF	405 SF 80 BULBS
SOFT SURFACE TRAIL	2'-6" WIDTH	

WATER QUALITY FACILITY MATERIALS LEGEND

TREES ITEM	SIZE / SPACING	QUANTITY
ACER GRISEUM PAPERBARK MAPLE	1.5" CAL. / B&B AS SHOWN	2
ALNUS RUBRA RED ALDER	1.5" CAL. / B&B AS SHOWN	3
PSEUDOTSUGA MENZIESII DOUGLAS FIR	6' HT / B&B AS SHOWN	1
EXISTING TREES TO REMAIN	AS NOTED	

SHRUBS & ACCENTS ITEM	SIZE / SPACING	QUANTITY
MAHONIA AQUIFOLIUM OREGON GRAPE	2 GALLON 7 PLANTS / 100 SF	69
CORNUS SERICEA RED TWIG DOGWOOD	2 GALLON 7 PLANTS / 100 SF	69
ROSA NOOTKANA NOOTKA ROSE	2 GALLON 7 PLANTS / 100 SF	69

GROUNDCOVERS & MISCELLANEOUS ITEM	SIZE / SPACING	QUANTITY
ARCTO. UVA-URSI 'MASSACHUSETTS' MASSACHUSETTS KINNICKINNICK	1 GALLON 70' / 100 SF	2,471 SF 1,729 PLANTS
SEDGE / RUSH MIX 50% CAREX STIPATA 50% JUNCUS PATENS	1 GALLON 80 PLANTS / 100 SF	7,343 SF 5,874 PLANTS

STORMWATER FACILITY REQUIREMENTS:

ZONE A TOTALS: 7,343 SF
REQUIRES: 80 HERBACEOUS / 100 SF = 5,874 HERBACEOUS
PROPOSED: 5,874 HERBACEOUS

ZONE B TOTALS: 2,946 SF
REQUIRES: 7 SHRUBS / 100 SF = 207 SHRUBS
PROPOSED: 207 SHRUBS (MIX OF SPECIES)

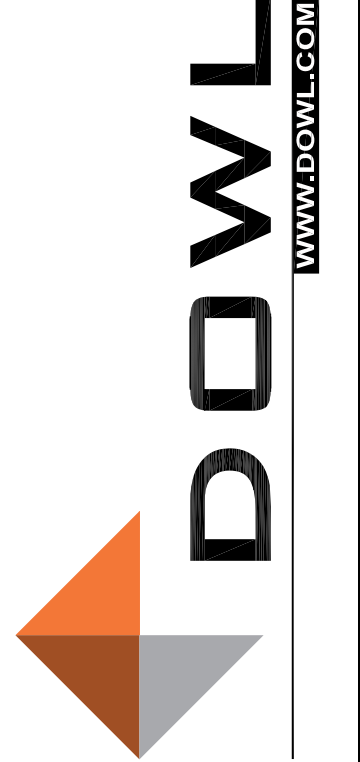
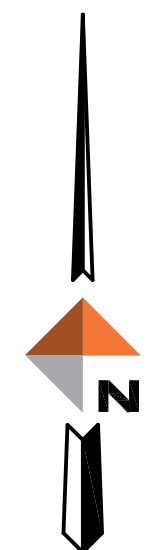
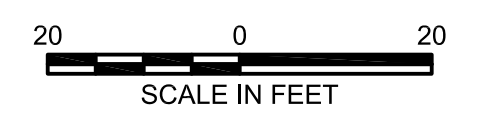

KELLOGG CREEK SUBDIVISION
PLANTING PLAN - ENLARGEMENTS
BROWNSTONE DEVELOPMENT
MILWAUKIE, OREGON
SEC. 17 NE 1/4 SEC. 6 T2S R2E W.M. EXISTING TAXLOTS 600, 700, 900, 901

PROJECT 14258-01
DATE 04/07/2017

© DOWL 2016
SHEET

L110