

COUNCIL RESOLUTION No. 82-2022

**A RESOLUTION OF THE CITY COUNCIL OF THE CITY OF MILWAUKIE, OREGON,
ADOPTING THE REVISED CONCEPT PLAN FOR BOWMAN-BRAE PARK.**

WHEREAS the City Council has prioritized the development of Milwaukie’s undeveloped parks, and

WHEREAS the city has made it a practice to develop and revise concept plans for each of the various city parks, to guide the future physical and programmatic development of each park, and to ensure that adjacent neighborhoods and the community have improved access to recreational facilities and open space, and

WHEREAS the city has conducted an extensive public involvement process with the community to develop/revise the conceptual plan for Bowman-Brae Park, and

WHEREAS the conceptual plans provide a clear vision for future improvements and amenities to the park site.

Now, Therefore, be it Resolved by the City Council of the City of Milwaukie, Oregon, that the new / revised concept plan for Bowman-Brae Park is adopted.

Introduced and adopted by the City Council on **December 6, 2022**.

This resolution is effective immediately.



Mark F. Gamba, Mayor

ATTEST:

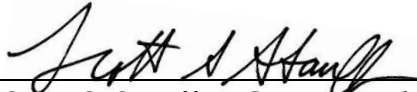

Scott S. Stauffer, City Recorder

APPROVED AS TO FORM:



Justin D. Gericke, City Attorney

TREE KEY:

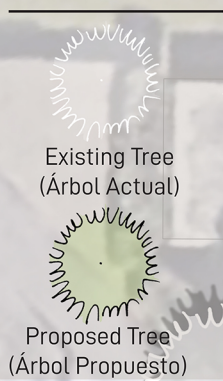

Existing Pump House
(Estación de bombeo actual)

Property to be Acquired
(Propiedad será Adquirida)



LEGEND (LEYENDA)

- | | | | |
|---|--|--|--|
| 1 Stormwater Swale
(Pantano de aguas de tormentas) | 4 Bench
(Banco) | 7 Picnic Shelter
(Área cubierta para comer) | 10 Log
(Leño) |
| 2 6'-9' Wide Pathway
(Camino 6' - 9' de ancho) | 5 Bike Rack
(Portabicicletas) | 8 Screening Shrubs
(Arbustos de ocultación) | 11 Drinking Fountain
(Fuente de agua) |
| 3 Picnic Table (2)
(Mesa de pícnic -2) | 6 Main Park Entry
(Entrada principal) | 9 Pollinator Garden
(Jardín de Polinizadoras) | 12 Entry Sign
(Letrero de Entrada) |

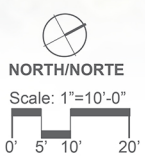

November 2022/Noviembre 2022